

## 64 5/16" Top Loading Bottle Cooler Bar Refrigerator

### Model: PLM-B65A



- Tested to NSF Standard 7 requirements for open food storage.
- Bright stainless steel interior.
- Exterior cabinet construction consists of black powder coated steel front and sides.
- Stainless steel sliding lids with locks.
- The electronic thermostat with a digital LED display for accurate control is located in the lower-right front access panel.
- Interior LED lighting.
- Convenient internal drain located near the front left corner and the corresponding external drain located on bottom right.
- Self-contained capillary tube system using environmentally friendly R290 Hydrocarbon gas.
- Front accessible condensing unit for easy cleaning and maintenance.
- Easy to mount plate casters (2 lockable) are standard with all units.

64 5/16" Top Loading Bottle Cooler Bar Refrigerator

Model: PLM-B65A

•Certified to ANSI/NSF Standard 7



MODEL	EXTERNAL DIMENSION inch	V/Hz/Ph	STORAGE CAPACITY Cu-ft	TEMPERATURE	REFRIGERANT	HP	AMPS	NUMBER OF DOOR	NEMA PLUG	SHIPPING WEIGHT (lbs.)
PLM-B65A	64 5/16 x 27 x 35	115V/60Hz/1	17.2	33°F-41°F	R290	1/2	3	2	5-15P	353

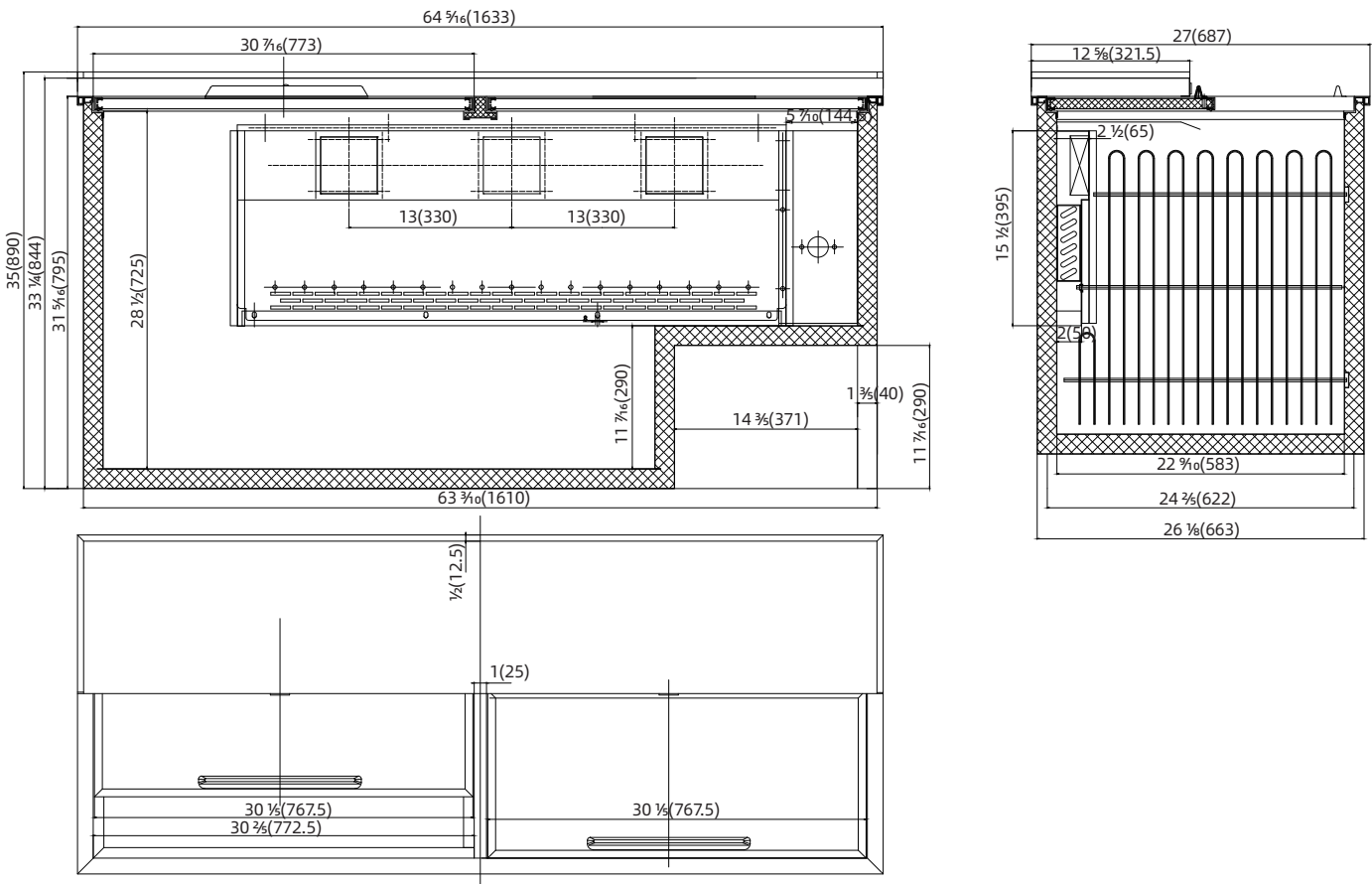

2 YEAR PARTS WARRANTY  
5 YEAR COMPRESSOR WARRANTY

