

61" Back Bar Bottle Cooler Sliding Door

Model: PLM-BC3-24SD



- Tested to NSF Standard 7 requirements for open food storage.
- Mirror finish stainless steel interior with high-grade stainless steel coved corner floor.
- Exterior cabinet construction consists of black powder coated steel front and sides.
- Electronic thermostat with digital LED display for accurate control located behind front access panel.
- Interior LED lighting.
- Top is 1.5" solid foamed stainless steel.
- 24" depth conserves important work space.
- Each door is equipped with magnetic gaskets that are removable for cleaning.
- Front accessible condensing unit for easy cleaning and maintenance.
- Front breathing.
- Self-contained capillary tube system using environmentally friendly CFC free refrigerant (R290).
- Easy to mount casters (2 lockable) are standard with all units.

61" Back Bar Bottle Cooler Sliding Door

Model: PLM-BC3-24SD

•**Certified to ANSI/NSF Standard 7**

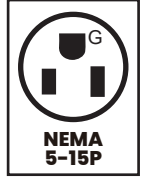

MODEL	EXTERNAL DIMENSION inch	V/Hz/Ph	STORAGE CAPACITY Cu-ft	TEMPERATURE	REFRIGERANT	AMPS	NUMBER OF DOOR	NEMA PLUG	SHIPPING WEIGHT (lbs.)
PLM-BC3-24SD	61 X 24 7/16 X 36 1/4	115V/60Hz/1	16.6	33°F-41°F	R290	3	2	5-15P	348

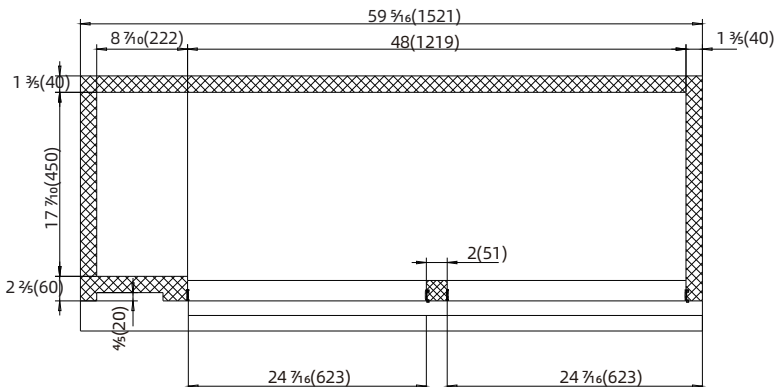
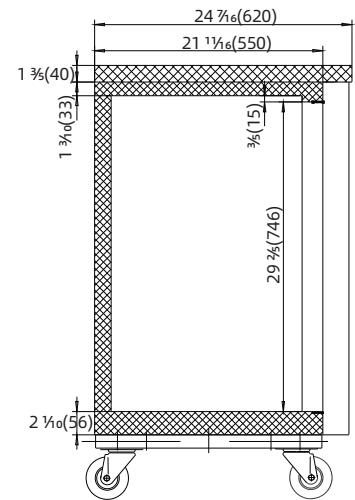
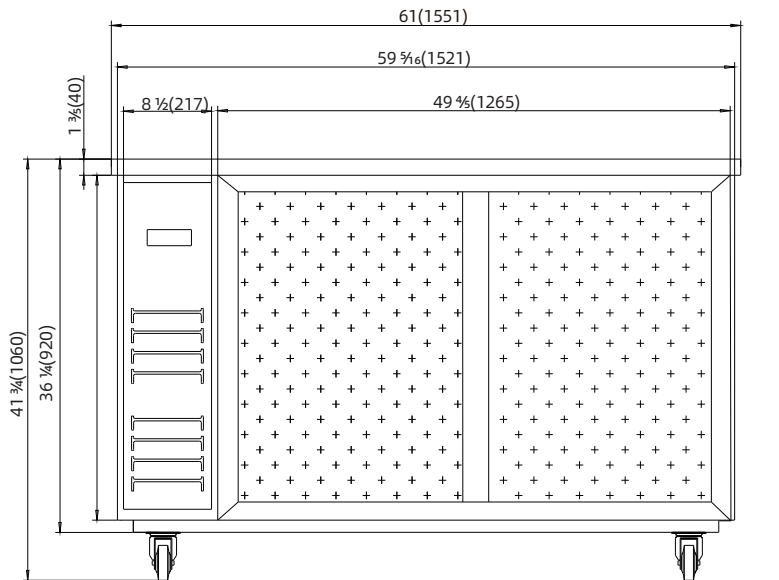

2 YEAR PARTS WARRANTY
5 YEAR COMPRESSOR WARRANTY



CHEFMIND GROUP INC.

SPECIFICATIONS SUBJECT TO CHANGE WITHOUT NOTICE