

# 24 1/8" Beer Kegerator Beer Dispenser Cooler

## Model: PLM-BCBD1



- Tested to NSF Standard 7 requirements for open food storage.
- Standard one tower and one faucet.
- Bright stainless steel interior.
- Exterior cabinet construction consists of black powder-coated steel front and sides.
- Reinforced stainless steel threshold and floor.
- Electronic thermostat with digital LED display for accurate control, located behind front access panel.
- Top is 1.5" thick solid foam-cored stainless steel.
- 24" depth conserves important workspace.
- Standard with interior top-ventilated s/s duct to allow for even temperature across all doors.
- Interior ventilated air duct becomes a convenient "chase-way" for cool-air vent tubes, which are directed up each beer tower to properly chill them.
- Front-accessible condensing unit for easy cleaning and maintenance.
- External drain mount.
- Mounted 4-way air distributor, located on back wall, top left.
- Interior LED lighting.
- Each door is equipped with locks and magnetic gaskets that are removable for cleaning.
- Easy-to-mount 3.25" casters (2 lockable) are standard with all units.

24 1/8" Beer Kegerator Beer Dispenser Cooler

Model: PLM-BCBD1

•Certified to ANSI/NSF Standard 7



MODEL	EXTERNAL DIMENSION inch	V/Hz/Ph	STORAGE CAPACITY Cu-ft	TEMPERATURE	REFRIGERANT	HP	AMPS	CORD LENGTH	NEMA PLUG	SHIPPING WEIGHT (lbs.)
PLM-BCBD1	24 1/8 X 29 1/16 X 51 1/8	115V/60Hz/1	8.1	33°F-41°F	R290	/	3	8'	5-15P	161

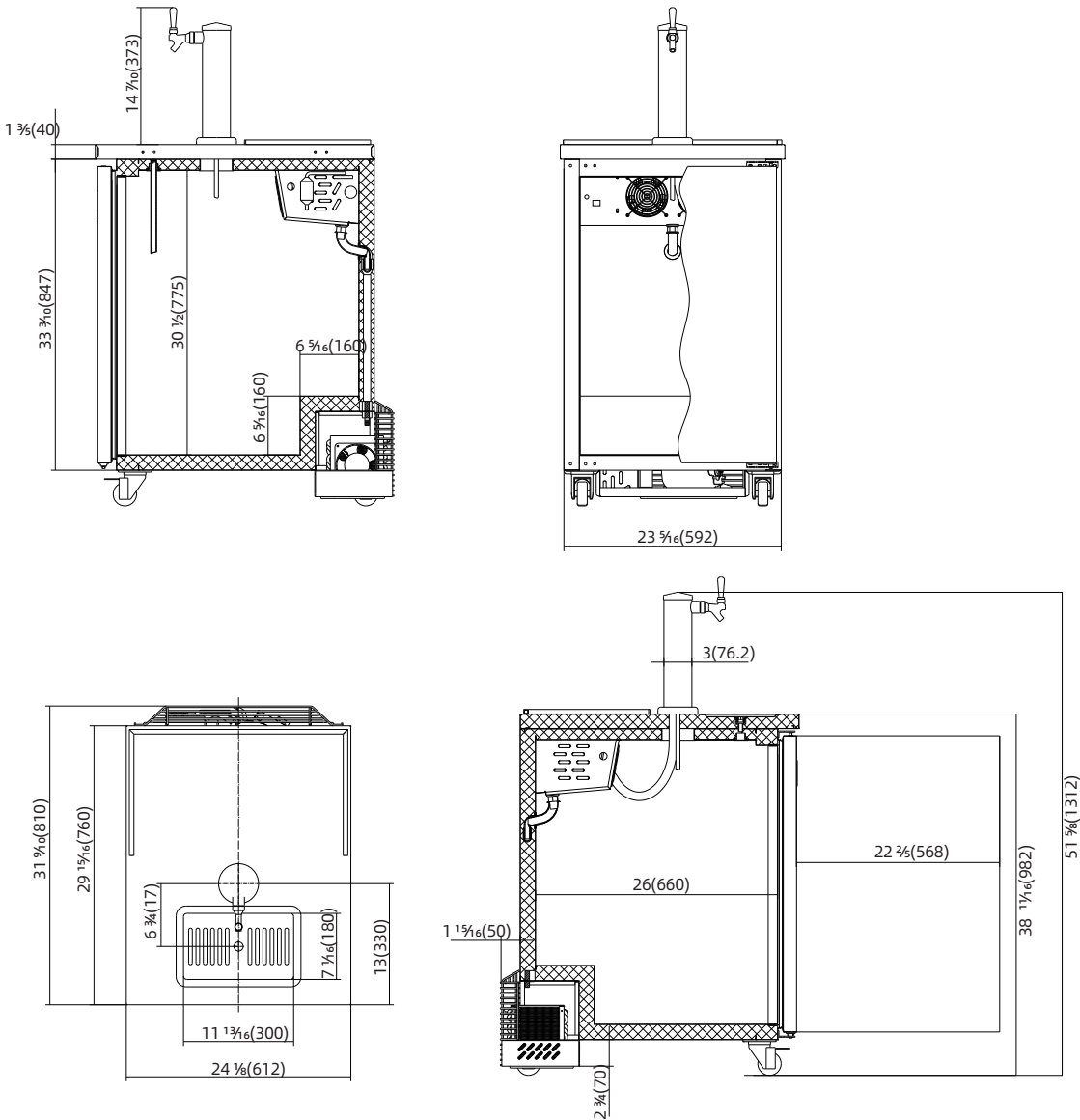

2 YEAR PARTS WARRANTY  
5 YEAR COMPRESSOR WARRANTY

