

## 28 15/16" Mega Top Salad Sandwich Prep Table

### Model: PLM-S29KS



- Tested to NSF Standard 7 requirements for open food storage.
- Interior cabinet is full stainless steel, floor with coved corners.
- Exterior cabinet construction consists of full stainless steel front and sides.
- 1/6 size 4" clear Lexan pans included.
- Added space allows for extra rows of pans.
- Full length, heavy-duty 5/8" thick cutting board is included.
- Electronic thermostat with external digital LED display for accurate control and easy reading.
- Large fan motors and blades for more efficient air flow ensuring faster temp recovery times.
- Efficient condensate hot gas loop built into condensate pan for energy saving evaporation of excess condensate water.
- Self contained capillary tube system using environmentally friendly R290 Hydrocarbon gas.
- Vaulted self closing doors that remain open at 90 degrees.
- Magnetic door gaskets are removable and replaceable without tools.
- Easy to mount plate casters (2 locking) are standard with all units.

**Toll Free: +1 (800) 373-8699**  
**polarman@chefmindgroup.com**  
Address: 1189S Jellick Ave,  
City of Industry, CA 91748



28 15/16" Mega Top Salad Sandwich Prep Table

Model: PLM-S29KS

•Certified to ANSI/NSF Standard 7



MODEL	EXTERNAL DIMENSION inch	V/Hz/Ph	STORAGE CAPACITY Cu-ft	NUMBER OF DOOR	TEMPERATURE	REFRIGERANT	AMPS	CORD LENGTH	NEMA PLUG	SHIPPING WEIGHT (lbs.)
PLM-S29KS	28 15⁄16 x 34 1⁄2 x 43 3⁄8	115V/60Hz/1	7	1	33°F-41°F	R290	3	8'	5-15P	276

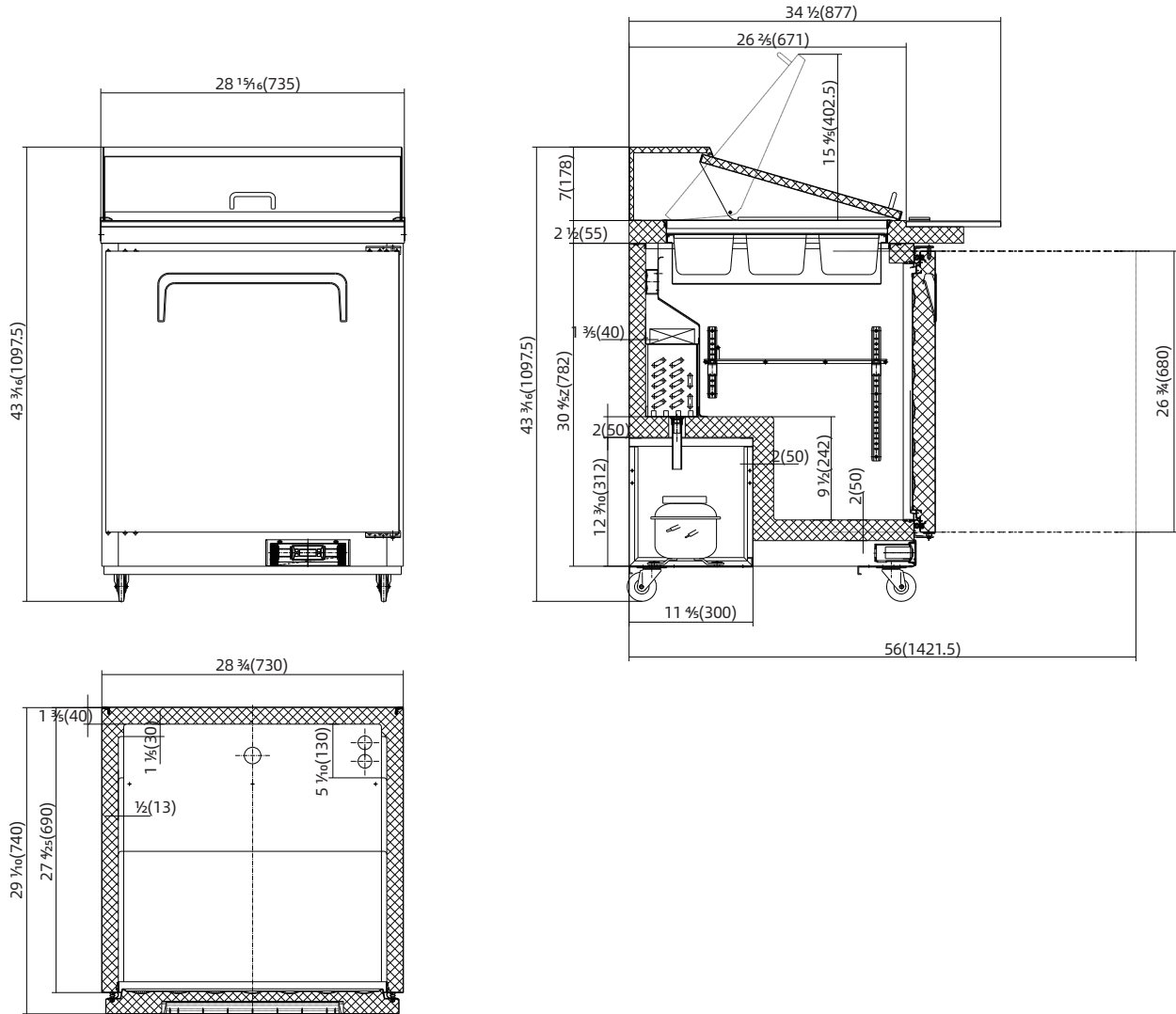

2 YEAR PARTS WARRANTY  
5 YEAR COMPRESSOR WARRANTY

